

# Westport:

12' x 12' Pavilion

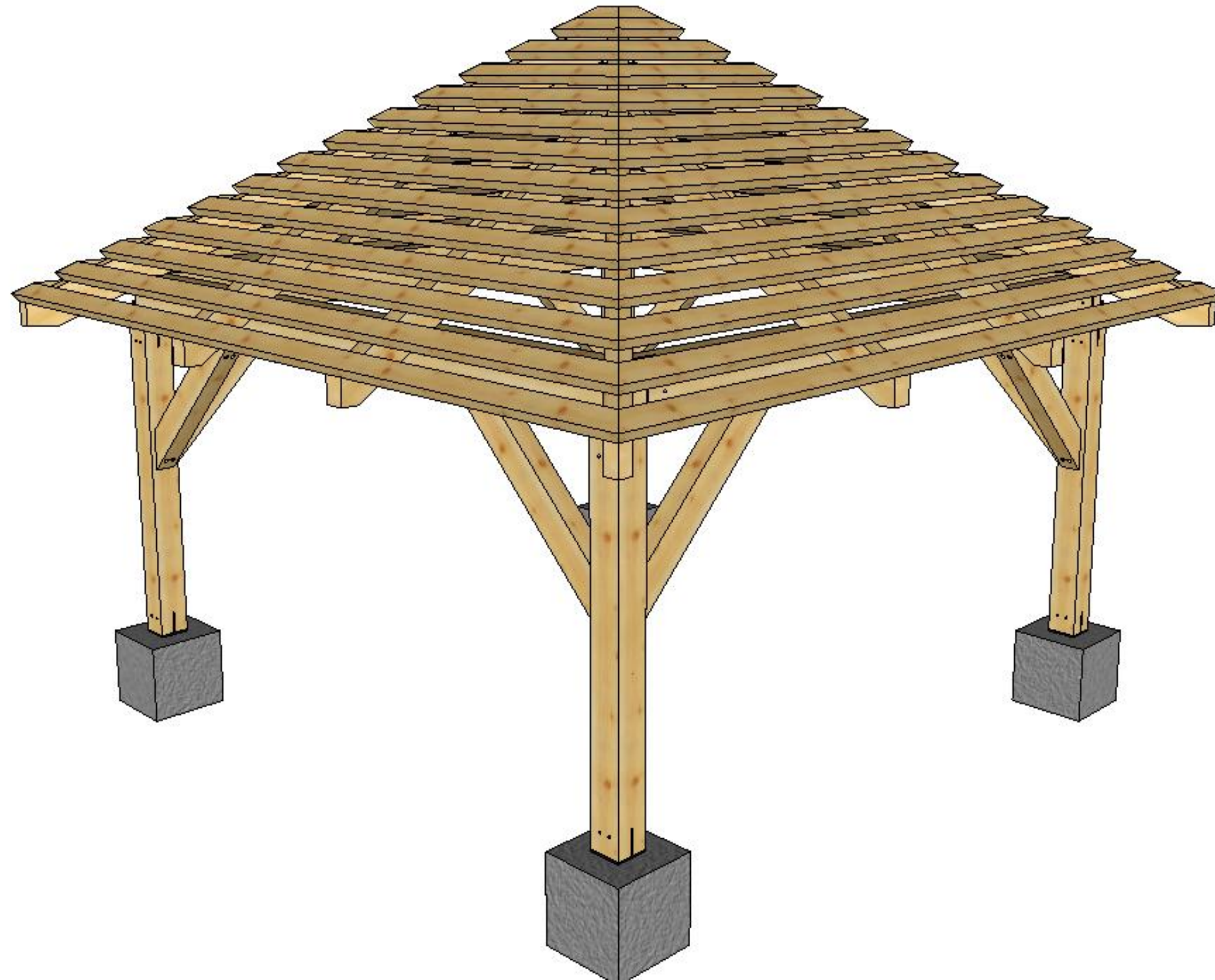

To be printed on- **11 x 17 Tabloid**

*All timbers shall be equivalent to Hemlock Fir  
No. 2 or better unless otherwise noted*



COPYRIGHT LAWS PROHIBIT REPRODUCTION OR USE OF THIS DRAWING IN WHOLE OR IN PART, WITHOUT THE EXPRESSED WRITTEN PERMISSION OF CONNEXT POST AND BEAM, LLC.

DO NOT SCALE DIMENSIONS ON THESE DRAWINGS. THESE IMAGES ARE MACHINE REPRODUCTIONS AND MAY CONTAIN A MARGIN OF ERROR.

**CONNEXT**  
POST & BEAM

12' x 12'

Revisions:  
3/24/2020

DRAWING INFO:  
Cover Sheet

DRAWING No. 000  
PRINTED: 3/24/2020

# Timber List

Wood Type	Item	QTY	W	H	L	BF
HF	PB1	2	6	10	12'	120
HF	KB1	8	4	6	3'-8"	59
HF	HR1	4	4	8	11'-5 13/16"	122
HF	R2	4	4	6	6'-7"	52
HF	R1	4	4	6	6'-7"	52
HF	TB1	2	6	10	10'-11 1/8"	109
HF	P1	4	6	6	5'-7 1/8"	67
HF	HB	28	2	4	16'	299

Wood Type	Pcs.	Volume[BF]
HF	56	880

# Fastener List

Item	Pieces
CR6010	4
CR6060	8
1/2" Pins	28
3 1/2" GRK RSS Screws	48
5" GRK Caliburn Screws	24
8" GRK RSS Screws	48
12" GRK RSS Screws	12
1" Hardwood Plugs	48
3/4" x 2'-4" Threaded Rod	2
3/4" Washers	4
3/4" Nuts	4

*This timber list and fastener list is just a guideline. Please check and verify that all dimension are correct before ordering materials.*

*Connex is not responsible for left over materials.*

# General Notes:

- 1). The frame design shown has not been engineered and is only intended as a general outline. It is the sole responsibility of the homeowner and/or contractor to determine if local or state code requires an engineer's stamp on plans before erection. Connex does not design to a specific area and for that matter will not hold any reasonability or warranty plans if plans do not satisfy the requirements of local and/or state building codes.
- 2). The homeowner/contractor is responsible for locating and the protection of all existing utilities and adjacent structures throughout all phases of construction.
- 3). The homeowner and/or contractor (builder) is responsible for implementing job site safety and construction procedures in accordance with national, state, and local safety requirements. The design, adequacy and safety of erection, bracing, shoring, temporary supports, etcetera is the sole responsibility of the builder. The builder is responsible for the stability of the structure prior to the completion of all gravity and lateral framing, roof and floor diaphragms and finish materials. Connex assumes no responsibility for any changes or modifications that may be made to the plans by the builder.
- 4). These plans do not cover work in areas not explicitly shown on the plans, including stick framed portions, adjacent buildings, basements/crawl- space areas, or any other changes or modifications.
- 5). Homeowner/contractor shall verify all dimensions and job site conditions before commencing work and shall report any discrepancies to Connex if modifications need to be made.
- 6). Use written dimensions. Do not use scaled dimensions. Where no dimension is provided, consult Connex for clarification before proceeding with the work.
- 7). Timbers- Unless otherwise noted, solid sawn timber shall be equivalent to ungraded eastern white pine No. 2 or better. Timbers shall be rough sawn, and sized to full stated dimensions (e.g. 8x8 = 8.0" x 8.0").
- 8). Timber screws- Unless noted otherwise, all screws shall be GRK RSS, GRK Caliburn or Fastenmaster Timberloks. Screw holes shall not be pre-drilled unless otherwise noted.



COPYRIGHT LAWS PROHIBIT REPRODUCTION OR USE OF THIS DRAWING IN WHOLE OR IN PART, WITHOUT THE EXPRESSED WRITTEN PERMISSION OF CONNEXT POST AND BEAM, LLC.

DO NOT SCALE DIMENSIONS ON THESE DRAWINGS. THESE IMAGES ARE MACHINE REPRODUCTIONS AND MAY CONTAIN A MARGIN OF ERROR.

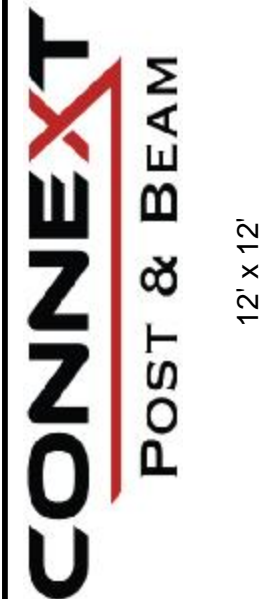

Revisions:  
3/24/2020

DRAWING INFO:  
Material List

DRAWING No. 001  
PRINTED: 3/24/2020

QTY	HF	Size
4x	P1	6 x 6 x 5'-7 1/8" +

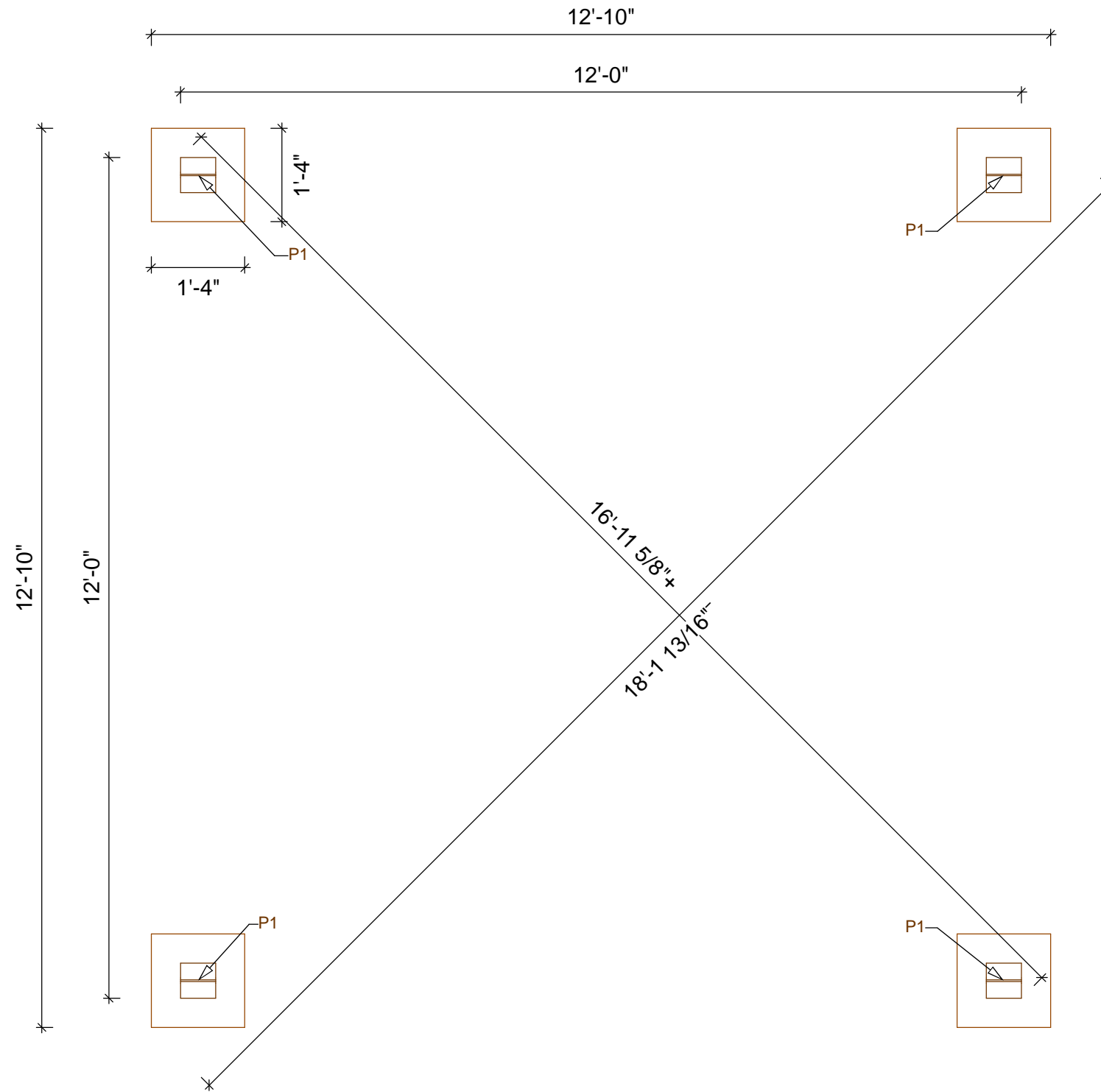

## Post Layout:

Scale: 1/2" = 1'-0"



COPYRIGHT LAWS PROHIBIT REPRODUCTION OR USE OF THIS DRAWING IN WHOLE OR IN PART, WITHOUT THE EXPRESSED WRITTEN PERMISSION OF CONNEXT POST AND BEAM, LLC.

DO NOT SCALE DIMENSIONS ON THESE DRAWINGS. THESE IMAGES ARE MACHINE REPRODUCTIONS AND MAY CONTAIN A MARGIN OF ERROR.

**CONNEXT**  
POST & BEAM  
12' x 12'

Revisions:  
3/24/2020

DRAWING INFO:  
Post Layout

DRAWING No. 002  
PRINTED: 3/24/2020